

NEW PRODUCT NOTIFICATION

Issue Date:	27/10/2016	Issued By:	Marketing	Release Date:	12/10/2016
-------------	------------	------------	-----------	---------------	------------

ADLT Part No:	XA-XCCSSKW-R	Product Name:	Surface mounted light trim kit for CPY250
---------------	--------------	---------------	---

Extended Description:

This trim kit has been engineered specifically to fit the Cree CPY250 Canopy Light, enabling it to be installed on roofs/ceilings that it cannot be recessed into.

Features:

- *Made from steel*
- *Default colour: white (powder-coated) (other colours available on request at additional cost)*
- *Supplied with 4 washers and 4 screws to attach the luminaire to the trim kit (Screws/bolts for fixing the light trim kit to desired surface NOT supplied)*
- *Installation instruction sheet included*
- *Weighs 3.04kg*

Photos:



CPY250 Surface Mounted Trim Kit



Trim Kit with Luminaire fitted (luminaire not included)



Diagram:

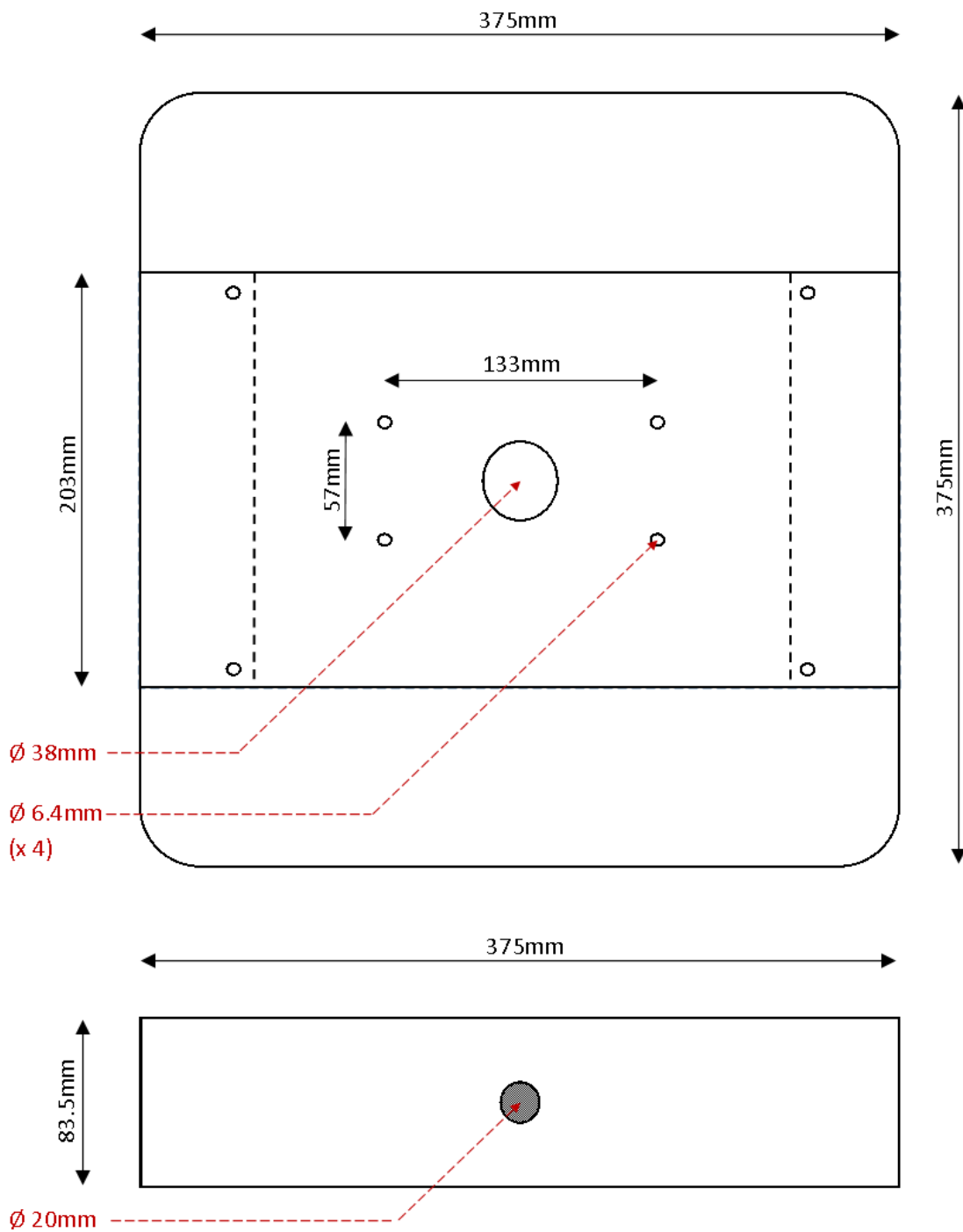

**Not to scale*

Installation Instructions:

- 1) *Using skirt as a guide, mark surface being mounted to and drill holes as necessary. Mount skirt to surface (screws not supplied).*

This side faces the desired surface.

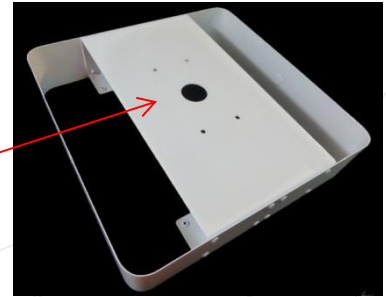

- 2) *Whether rear or side entry, run input cable into void and fit off plug provided.*

If using side entry, a gland is required (supplied by others).



- 3) *On the underside of the luminaire, push out the centres of the 4 x seals (pictured).*

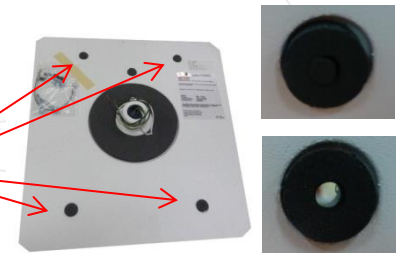

- 4) *Connect lead and attach luminaire to skirt using 4 x M5x20mm stainless steel screws and washers (supplied).*

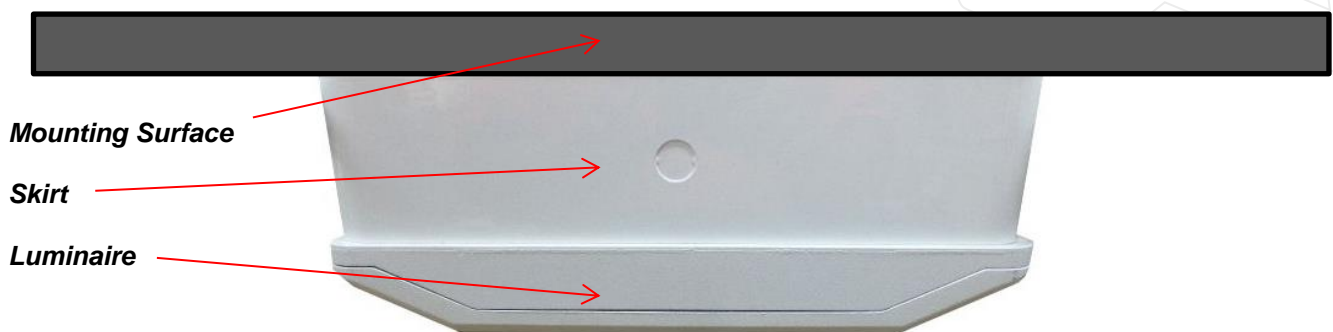
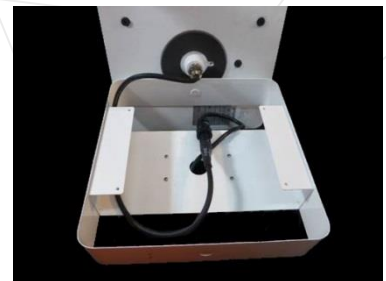

Mounting Surface

Skirt

Luminaire